

KSR Long Life-200,000 cycles-Gold and Silver Series Subminiature Tact Switch for SMT

Features/Benefits

- Saves PCB space
- Range of 4 actuation forces
- G terminations
- N.O.
- Detect type available
- Rubber actuator
- IP 50 sealed
- RoHS compliant and compatible

Typical Applications

- Automotive
- Cellular phones & accessories
- Industrial electronics
- Computers & network equipment



B

Tactile Switches

Specification

FUNCTION: momentary action
CONTACT ARRANGEMENT: Normally Open
TERMINALS: Gullwing type for SMT

Mechanical

Type	Operating force(Fa) Newtons (grams)	Operating life (operations)	Travel
Silver versions			
KSR212G LFS	1.5 < Fa < 2.2	200,000	0,25 ± 0,15
KSR222G LFS	1.9 < Fa < 2.6	200,000	0,3 ± 0,15
KSR232G LFS	2.25 < Fa < 3.75	200,000	0,35 ± 0,15
KSR252G LFS	3.37 < Fa < 5.6	200,000	0,5 ± 0,15
Gold versions			
KSR214G LFS	1.5 < Fa < 2.2	200,000	0,25 ± 0,15
KSR224G LFS	1.9 < Fa < 2.6	200,000	0,3 ± 0,15
KSR234G LFS	2.25 < Fa < 3.75	200,000	0,35 ± 0,15
KSR254G LFS	3.37 < Fa < 5.6	200,000	0,5 ± 0,15

Electrical

	Silver	Gold
MAXIMUM POWER:	1 VA	0.2 VA
MAXIMUM VOLTAGE:	32 V dc	32 V dc
MINIMUM VOLTAGE:	20 m Vdc	20 m Vdc
MAXIMUM CURRENT DC:	50 mA	50 mA
MINIMUM CURRENT DC:	1 mA	1 mA

CONTACT RESISTANCE: ≤ 100 m_Ω
INSULATION RESISTANCE (100 V): 1 G_Ω
BOUNCE TIME: 1 ms max

Environmental

	Silver	Gold
OPERATING TEMPERATURE:	-40°C to 85°C	-40°C to 125°C
STORAGE TEMPERATURE:	-55°C to 85°C	-55°C to 125°C

Process

SOLDERING: Compatible with the lead free soldering profile.

NOTE: Specifications listed above are for switches with standard options.
For information on specific and custom switches, consult Customer Service Center.

Mechanical

OVERLOAD: 20 Newtons

Packaging

Switches are delivered on continuous tape, in reels of 2,500 pieces.

How To Order

Our easy build-a-switch concept allows you to mix and match options to create the switch you need. To order, select desired option from each category and place it in the appropriate box.

However, please note that all the combinations of these options are not feasible.

For any part number different from those listed above, please consult your local representative.

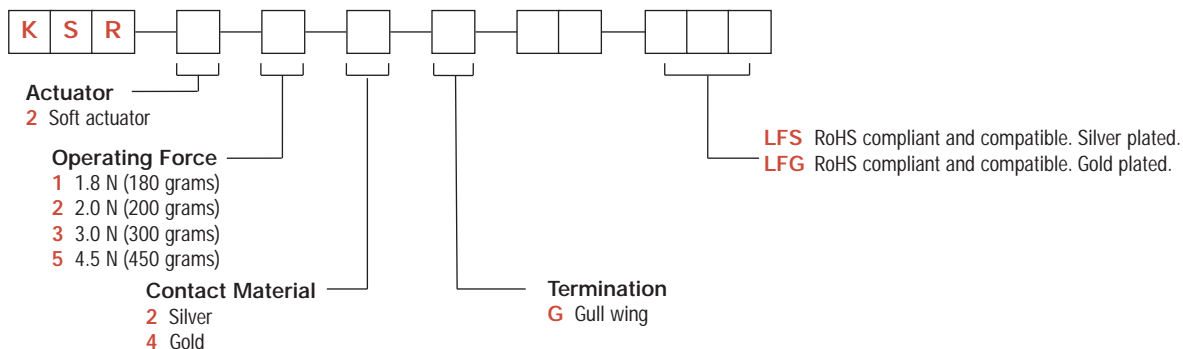

KSR Long Life-200,000 cycles-Gold and Silver Series Subminiature Tact Switch for SMT

KSR

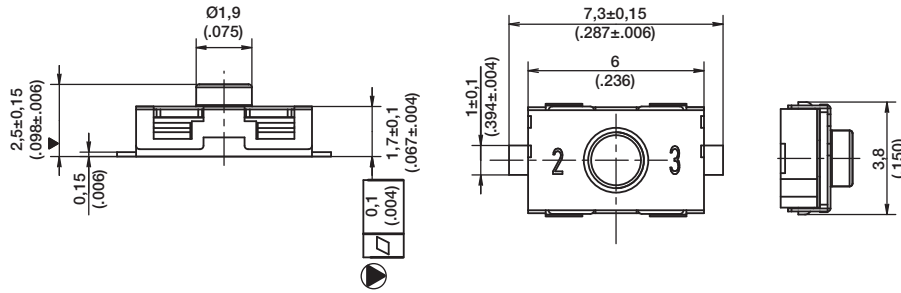

G GULLWING

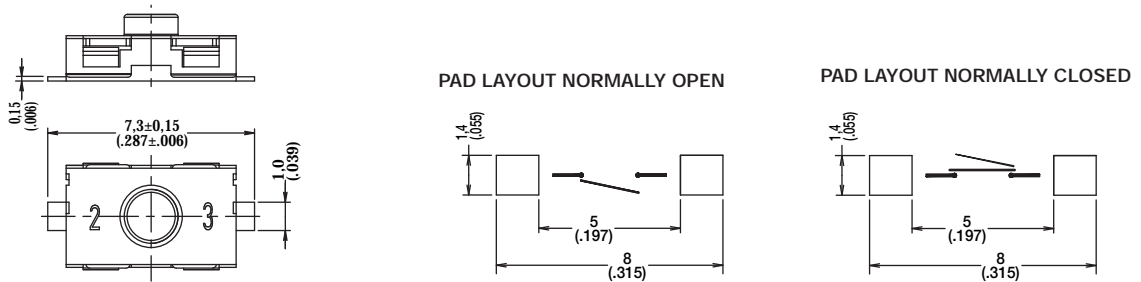

TAPE & REEL

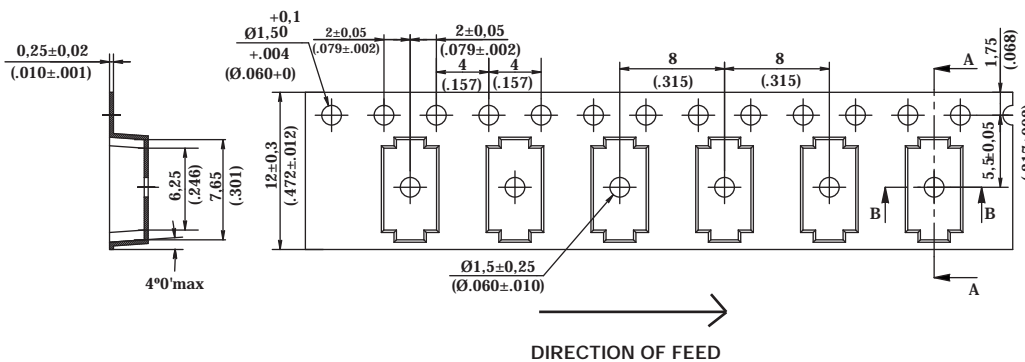

Dimensions shown in: mm (inch)
Specifications and dimensions subject to change

www.ck-components.com

Tactile Switches