

Terminal enclosures

Serie LDG-D

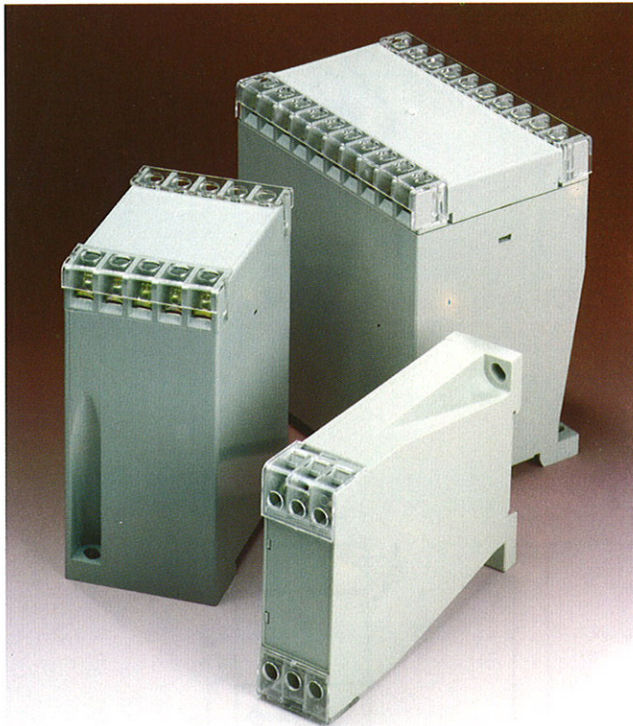

Key features

- External wiring via connection terminals with self-disengaging terminal disk and positive/minus screws, or via plug-in connection for flat-pin plugs
- Internal wiring between PC Board and connection terminals by means of wire connection or via flat-pin plug
- Individual terminal mounting
- Two-part construction
- Locating grooves for PC Boards of 1.6 mm thickness
- Fixing for 2 drill holes to DIN 46 121 and DIN 43 660, or snap-on fixing for standard rail to DIN 46 277 and DIN EN 50 022
- Creepage distances and clearances according to VDE 0110.

Design versions

LDG-D-6 ... max. 6 connections
 LDG-D-10 ... max. 10 connections
 LDG-D-20 ... max. 20 connections

Approvals

UL File no. E 84703
 CSA File no. LR 67018

Ordering information

LDG-D-6		Part No.
Enclosure	with 6 terminals mounted	404 000
	with 6 flat-pin plugs mounted	404 002
Side section		404 001
Terminal shrouding	transparent	404 004
LDG-D-10		Part No.
Enclosure		404 010
Cover	with 10 terminals mounted	404 011
	with 10 flat-pin plugs mounted	404 022
Terminal shrouding	transparent	404 014
LDG-D-20		Part No.
Enclosure		404 020
Cover	with 20 terminals mounted	404 021
	with 20 flat-pin plugs mounted	043 165
Terminal shrouding	transparent	404 024

General

The LDG-D series is a range of insulating-material enclosures in three different sizes, corresponding to the regulations of the machine construction and automotive industries.

With terminal shroudings for safe-to-touch terminals to VDE 0100 and to VBG 4.

Technical data

Protection class of enclosure	IP 40 (without mounted terminals) IP 20 (with mounted terminals and terminal shrouding)
Enclosure material: LDG-D-6 LDG-D-10/20	ABS (Terluran) 877T, UL94 HB Novodur, UL 94 HB
Terminal shrouding: LDG-D-6 LDG-D-10/20	Polystyrene 168N Macrolon 2800
Terminal	Angle CuZn 37, 2µm nickel-struck, 2µm tin-plated, sheet-steel terminal screw, chromized, cable cross-section to max. 4.0 mm ² , rated current 20 A
Flat-pin plug	CuZn 37, 7µm tin-plated, for tab receptacles 2.8 × 0.8 mm to DIN 46 247, rated current max. 10 A
Temperature range	-40°C to +85°C
Exterior dimensions: LDG-D-6 LDG-D-10 LDG-D-20	L 25.0 × W 70.0 × H 103.0 mm L 50.0 × W 70.0 × H 103.0 mm L 100.0 × W 70.0 × H 110.0 mm

Dimensional drawings

Enclosure LDG-D-6

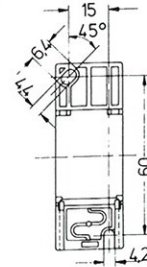
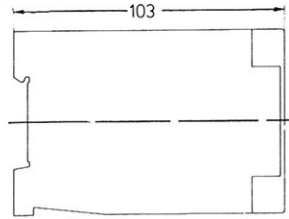
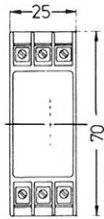

Enclosure LDG-D-10

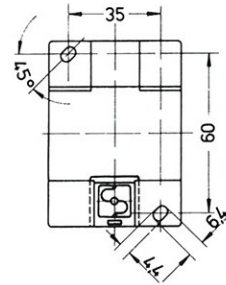
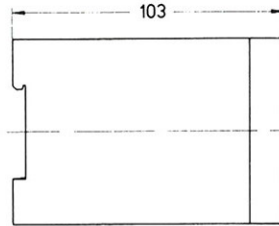
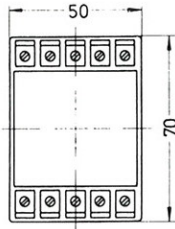

Enclosure LDG-D-20

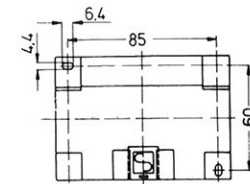
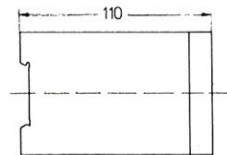
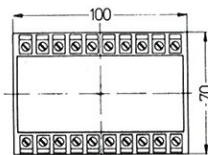

Recommended PC board

LDG-D-6

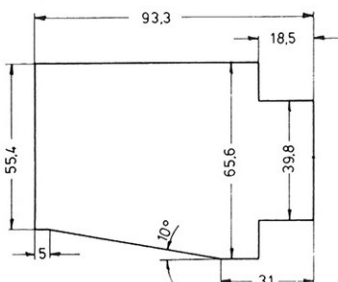

LDG-D-10

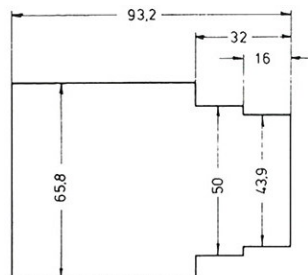

LDG-D-20

