

## AMP 2.2

### Art. No. 7100

**Stereo amplifier** with level controls, e.g. for multimedia applications. Suitable for use with small loudspeakers with impedances of 4 to 8 ohms.

Robust metal housing with two fixing lugs. Can be connected directly to the line out or headphones socket of a PC audio card, while the input [sensitivity](#) is regulated via the level control. Power supply (12 V) is via a mains adapter (not supplied) or the computer's on-board power supply. Short-circuit proof.



#### Typical applications:

- Info terminals
- Computer displays
- Showcases

Technical Data:	
Power supply	12 V DC
Quiescent current	46 mA
Input <a href="#">impedance</a>	10 kOhm
Max. current consumption	1.1 A
Power output (sine, 1% / 5% / 10% THD)	2 x 2.1 / 3.1 / 3.3 W (4 Ohm) 2 x 1.6 / 1.9 / 2.1 W (8 Ohm)
Input voltage (full conduction)	60 mV
Output <a href="#">impedance</a>	1.1 Ohm

SNR	61 dB (A) / 59 dB (ext)
Frequency response (-3 dB)	40 Hz–40 kHz
Terminal In-/Output	jack 3.5 mm stereo
Terminal DC	5.4 mm outer diam. (-) 2.1 mm inner diam. (+)
Net weight	0,178 kg
Temperature range	-10 ... 50 °C

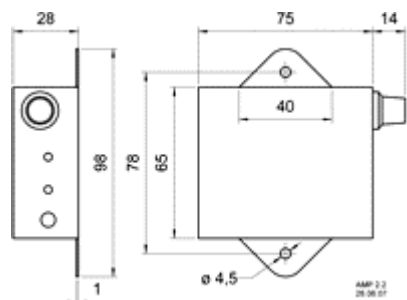

sketch