

Signal lamps with lamp socket - BA 9s (MBC/MCC), 16.2 mm



Pict.: transparent colourless

yellow

Panel cut-out

Technical Data

General information

Form of lens	see order block
Colour of lens	see order block
Diameter of collar	see order block

Dimensions

Overall height	see order block
Mounting depth	45.8 mm
Mounting hole	16.2 mm

Mechanical design

Mounting	ring nut
Terminals	solder/quick connector 6.3x0.8 / 2x2.8x0.8mm
Lamp socket	BA 9 s
Lamp	filament lamp

Electrical characteristics

Voltage limit max.	250 V
Power limit max.	2 W

Other specifications

Degree of protection from front side	see order block
Weight	10 g

3

Approvals



VDE 0710

With
Socket

Typical accessories Signal lamps with lamp socket - BA 9s (MBC/MCC), 16.2 mm

Description	Photo	Order no.	Additional accessories see page
Protective sleeve for terminals made of Buna N (NBR)		5.52.011.027/0100	
Fixing spanner M 15, M 16		5.58.002.019/0105	5 - 21

Signal lamps with lamp socket - BA 9s (MBC/MCC), 16.2 mm, round lens

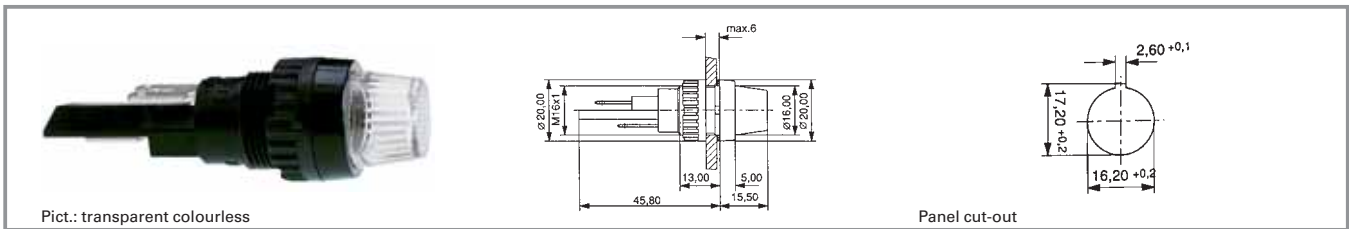

Voltage limit max.	Power limit max.	Degree of protection from front side	Colour of lens	Order no. complete	Order no. single parts	
					Housing	Lens
250 V	2 W	IP40	transparent colourless	1.63.004.001/1002	1.63.004.091/0000	5.49.205.013/1002
250 V	2 W	IP40	transparent red	1.63.004.001/1301	1.63.004.091/0000	5.49.205.013/1301
250 V	2 W	IP40	transparent yellow	1.63.004.001/1402	1.63.004.091/0000	5.49.205.013/1402
250 V	2 W	IP40	transparent green	1.63.004.001/1502	1.63.004.091/0000	5.49.205.013/1502

Technical data see page 3 - 50

Accessoires:

- Filament lamp, BA 9s base (MBC/MCC), 12 - 15 V: **1.90.060.132/0000**
- Filament lamp, BA 9s base (MBC/MCC), 24 - 30 V: **1.90.060.133/0000**
- Filament lamp, BA 9s base (MBC/MCC), 110 - 130 V: **1.90.060.137/0000**
- Neon lamp BA 9s (MBC/MCC), 220 V AC: **1.90.560.102/0000**

Technical data lamps see chapter 5

Signal lamps with lamp socket - BA 9s (MBC/MCC), 16.2 mm, round lens

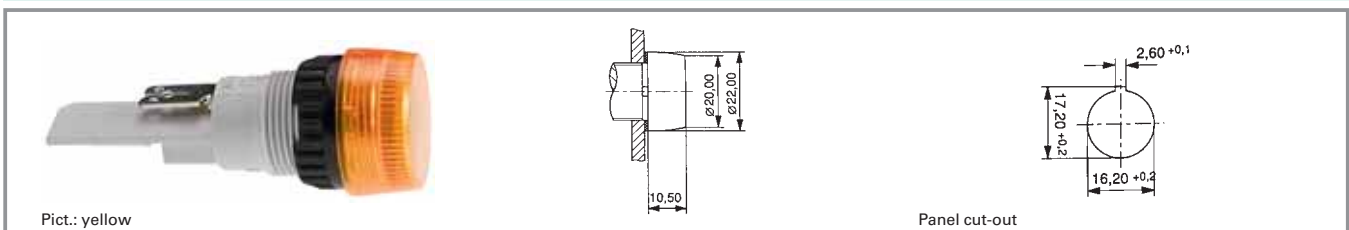

Voltage limit max.	Power limit max.	Degree of protection from front side	Colour of lens	Order no. complete	Order no. single parts	
					Housing	Lens
250 V	2 W	IP65	transparent colourless	1.63.004.010/1002	1.63.004.100/0000	5.49.227.007/1002
250 V	2 W	IP65	transparent red	1.63.004.010/1301	1.63.004.100/0000	5.49.227.007/1301
250 V	2 W	IP65	transparent yellow	1.63.004.010/1402	1.63.004.100/0000	5.49.227.007/1402
250 V	2 W	IP65	transparent green	1.63.004.010/1502	1.63.004.100/0000	5.49.227.007/1502

Technical data see page 3 - 50

Accessoires:

- Filament lamp, BA 9s base (MBC/MCC), 12 - 15 V: **1.90.060.003/0000**
- Filament lamp, BA 9s base (MBC/MCC), 24 - 30 V: **1.90.060.014/0000**
- Neon lamp BA 9s (MBC/MCC), 220 V AC: **1.90.560.002/0000**

Technical data lamps see chapter 5