

Hexagonal locknut

2xx PG

Configuration

Hexagonal locknut	Polystyrene
Internal thread	Pg as per DIN 40430

Properties

Temperature range	-20°C +70°C	<ul style="list-style-type: none"> for secure tightening of cable glands and accessories
-------------------	----------------	---

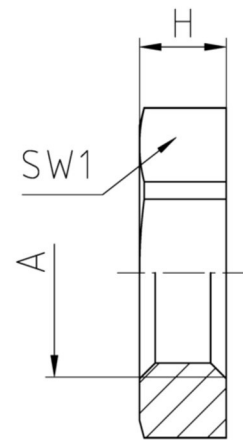

Features



RAL 7035

A	SW1	H		Part No.
	mm	mm	Piece	
Pg 7	19	5	100	207 PG
Pg 9	22	5	100	209 PG
Pg 11	24	5	100	211 PG
Pg 13,5	27	6	100	213 PG
Pg 16	30	6	100	216 PG
Pg 21	36	7	100	221 PG
Pg 29	46	7	100	229 PG
Pg 36	60	8	50	236 PG
Pg 42	65	8	50	242 PG
Pg 48	70	8	50	248 PG