



# Elektrotechnik Karl-Heinz Mauz GmbH

GM25-370-11670-500-12D8 (Artikel-Nr. 860525)

**EKULIT**

## *SPECIFICATIONS:*

Item	Unit	Specification
Rated voltage	VDC	12.0
Gear Ratio		1/226
Rotation		CW&CCW
Motor Position		All position in horizontal
Temperature	°C	0~30
Humidity	%	30~95
<b>• Performance of Motor</b>		
No-load Speed	rpm	3.000±10%
No-load Current	mA	40 (max.)
Stall Current	mA	500 (max.)
Stall Torque	g.cm	80
<b>• Performance of Gear motor</b>		
Output Speed	rpm	13±10%
No-load Current	mA	50 (max.)
Stall Current	mA	500 (max.)
Stall Torque	kg.cm	13
Rated Torque	g.cm	4000
Rated Current	mA	220 (max.)
Noise	dB	52
<b>• The Dimension</b>		
The Outside Shaft Length	mm	12
Shaft End Play	mm	0.05-0.50
Screw Size		M3
Dia of Shaft	mm	Ø4*D3.5

Adresse: Felix-Wankel-Str. 35 • 73760 Ostfildern/Nellingen

Tel: +49-711/3414023

Fax: +49-711/3414024

E-mail: [info@ekulit.de](mailto:info@ekulit.de) Web site: [www.EKULIT.de](http://www.EKULIT.de)

# Elektrotechnik Karl-Heinz Mauz GmbH

**GM25-370-11670-500-12D8** (Artikel-Nr. 860512)

**EKULIT**

**DIMENSIONS :**

(Unit: mm)

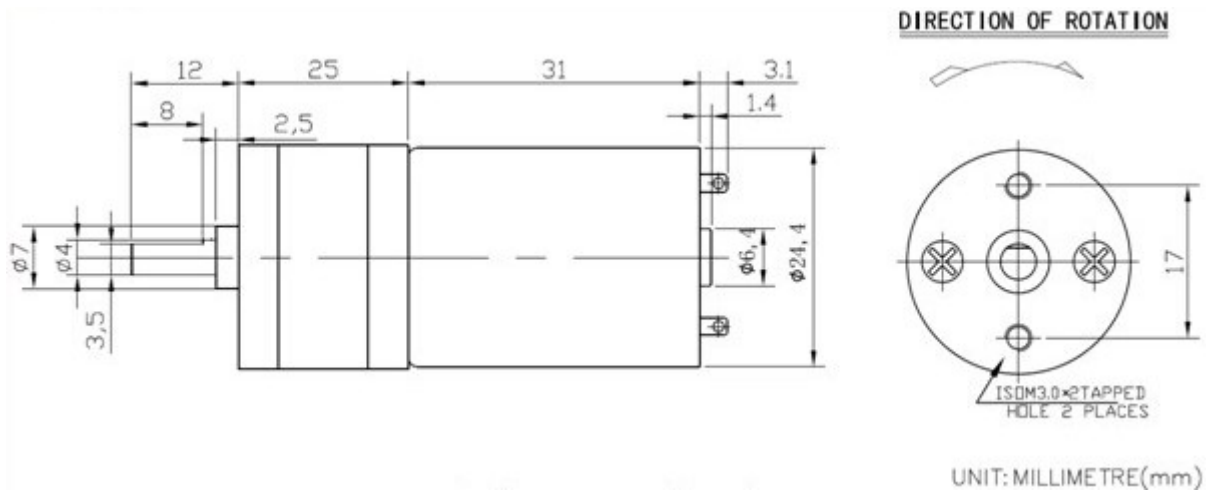

**Curve drawings:**

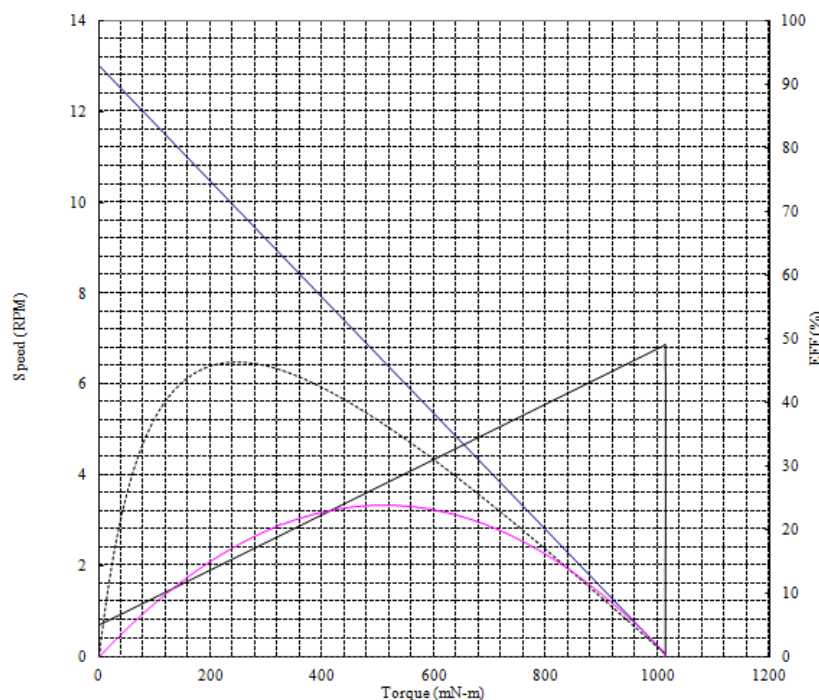

Adresse: Felix-Wankel-Str. 35 • 73760 Ostfildern/Nellingen

Tel: +49-711/3414023

Fax: +49-711/3414024

E-mail: [info@ekulit.de](mailto:info@ekulit.de) Web site: [www.EKULIT.de](http://www.EKULIT.de)