

**PIN HEADER 2,00 mm**

**ID: 332**

STL 12-XXA / STL 22-XXA

Series 500

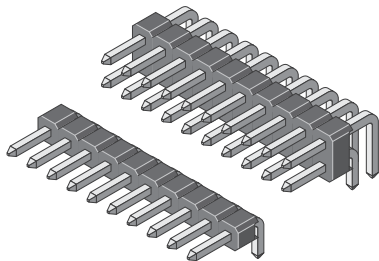

**TECHNICAL DATA**

Pitch	2,00 mm
Insulating Material	high temp. thermoplast UL94V-0
Contact Material	copper alloy
Rated Current	1,5 Amp.
Rated Voltage	100 V <sub>RMS</sub> / 150 V <sub>DC</sub>
Withstanding Voltage	500 V <sub>AC</sub> for one minute Operating
Temperature	-40°C to +105°C
Maximum Soldering Temperature	260°C for 10 seconds

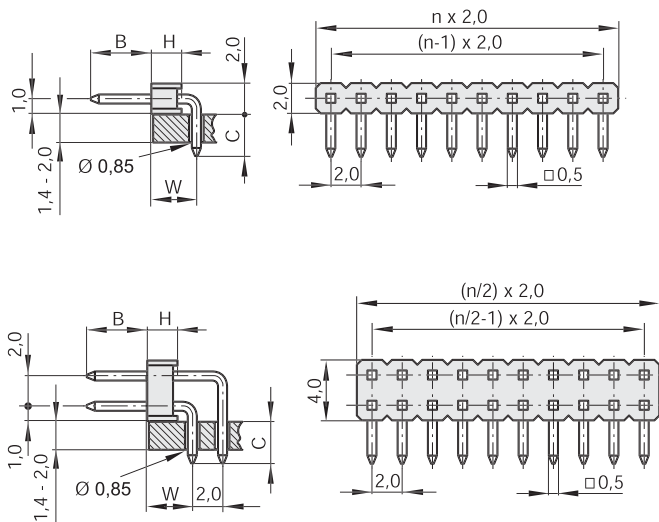

Code	Rows	B	C	W
01	2	3,80	2,50	1,85
02	1 / 2	4,00	2,50	3,00
03	1 / 2	4,00	2,85	3,02
04	1	4,00	2,45	3,13
Custom	_____	_____	_____	_____

All dimensions in mm.  
Other dimensions upon request.

STL XX - XX A XX - XX - XX U

XX: 12 = 1 row, pitch 2,00mm  
22 = 2 rows, pitch 2,00mm

Code: see table

A: right angled contacts

Plating: TT = Sn  
GT = sel. Au  
GG = Au

U: RoHS-compliant with high temp. plastic

Poles: 1 row: 2 - 40 contacts possible  
2 rows: 4 - 80 contacts possible

Insulator: 15 = insulator height H=1,5mm  
20 = insulator height H=2,0mm (not for Code 01)